

SEÇÃO 0.0
 ESCALA 1:100

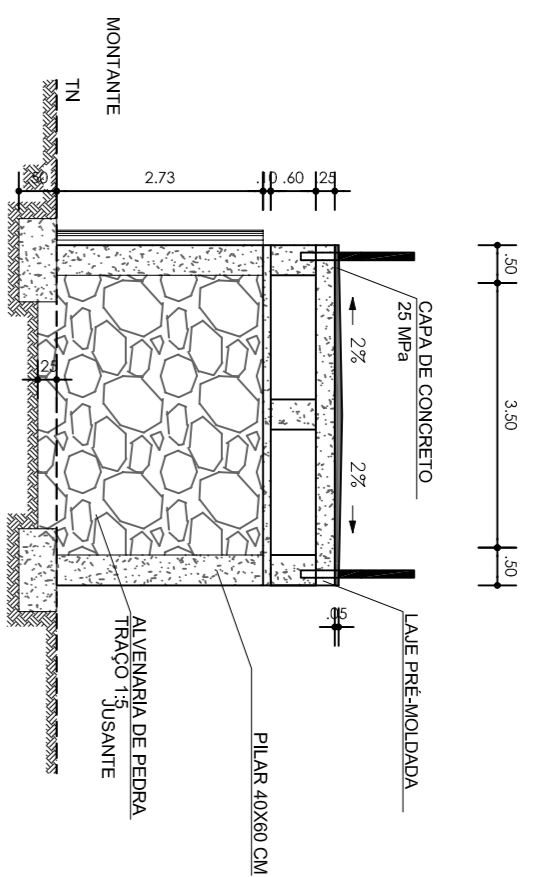

SEÇÃO 20D
 ESCALA 1:100

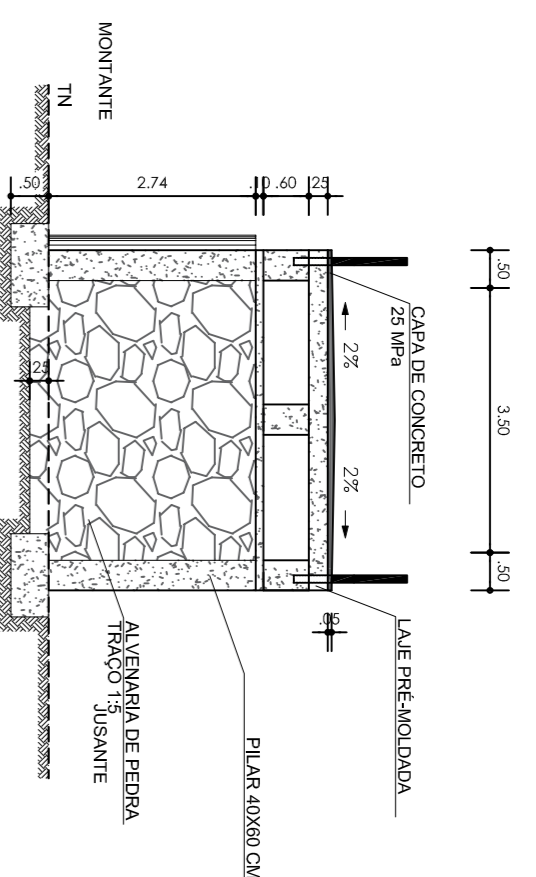

SEÇÃO 40D
 ESCALA 1:100

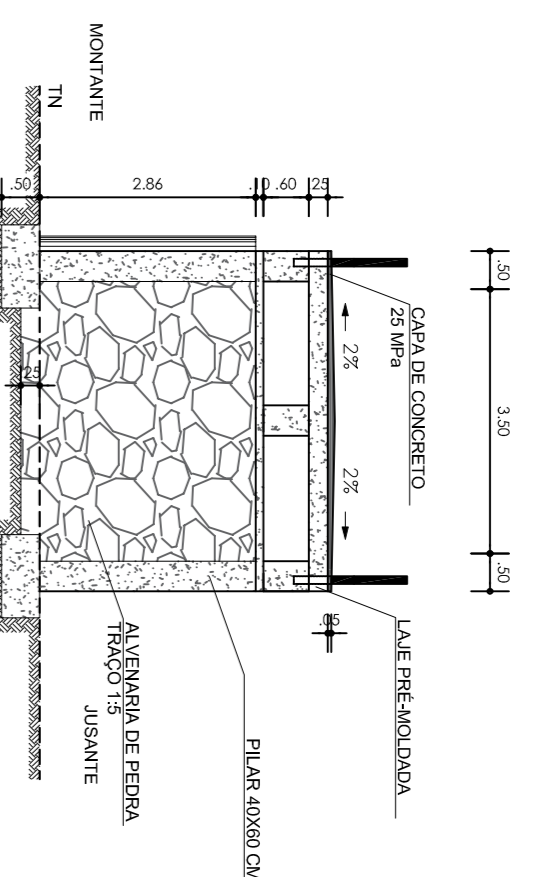

SEÇÃO 60D
 ESCALA 1:100

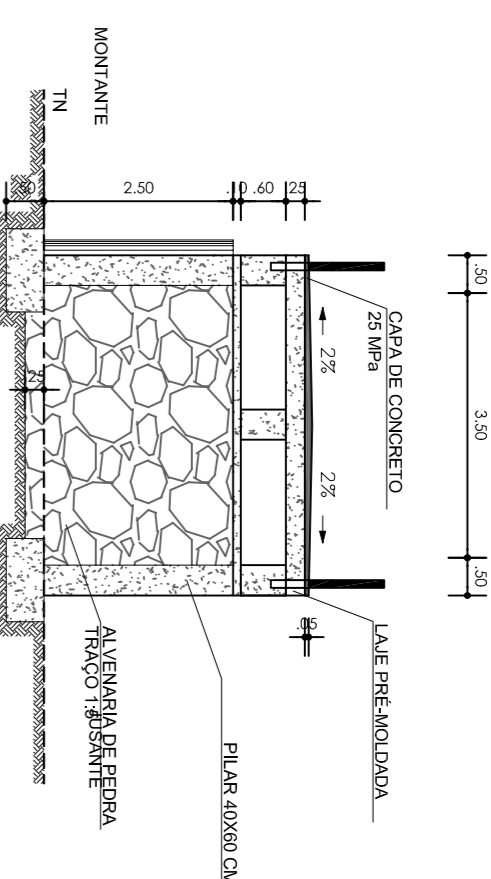

SEÇÃO 80D
 ESCALA 1:100

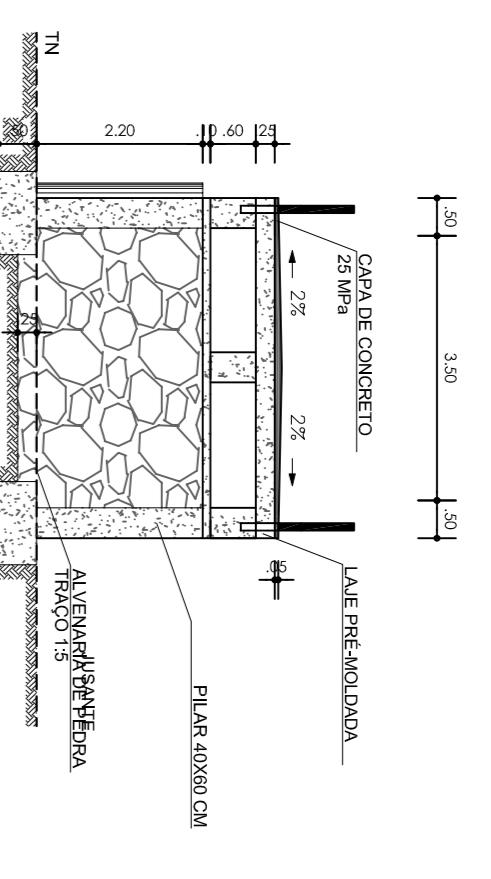

SEÇÃO 100D
 ESCALA 1:100

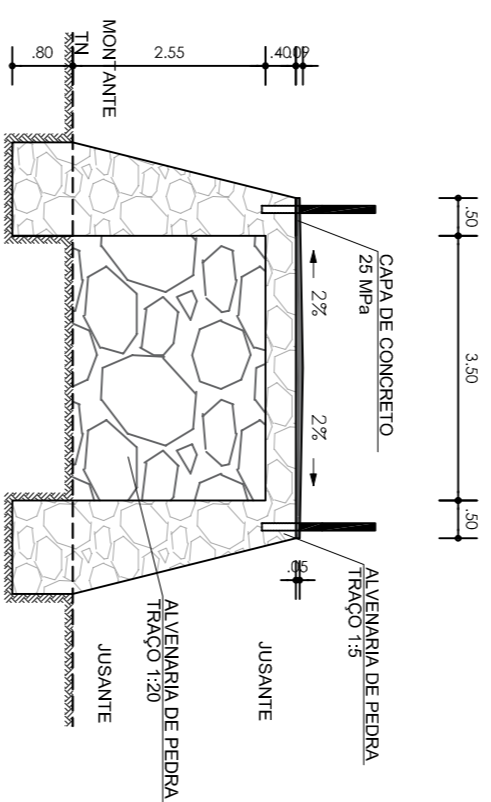

SEÇÃO 120D
 ESCALA 1:100

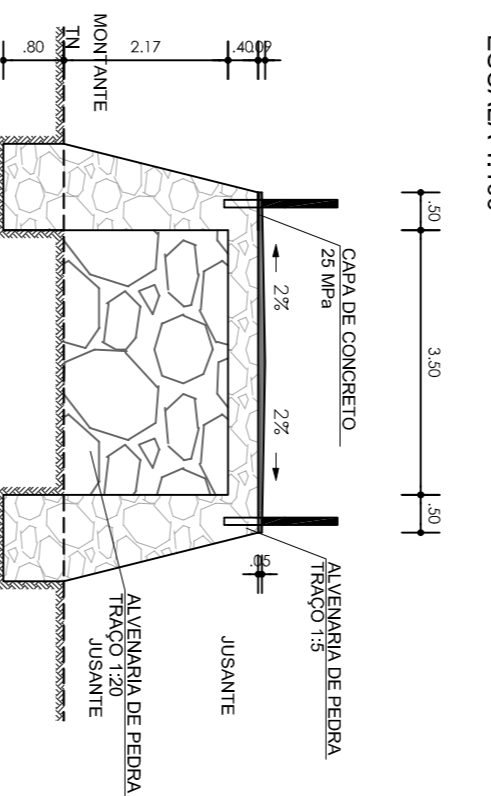

SEÇÃO 60E
 ESCALA 1:100

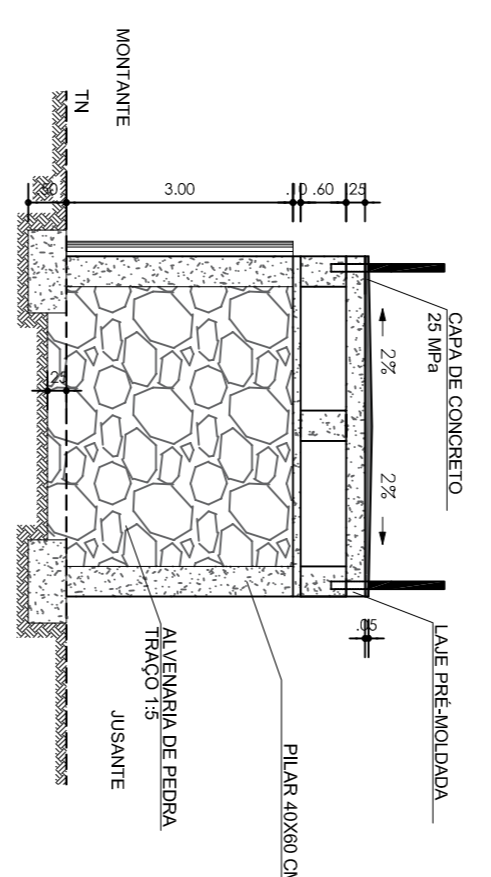

SEÇÃO 40E
 ESCALA 1:100

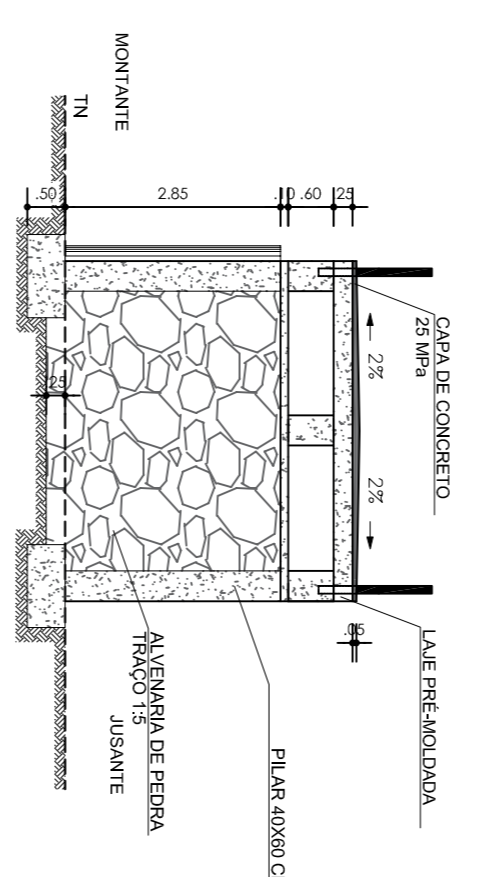

SEÇÃO 20E
 ESCALA 1:100

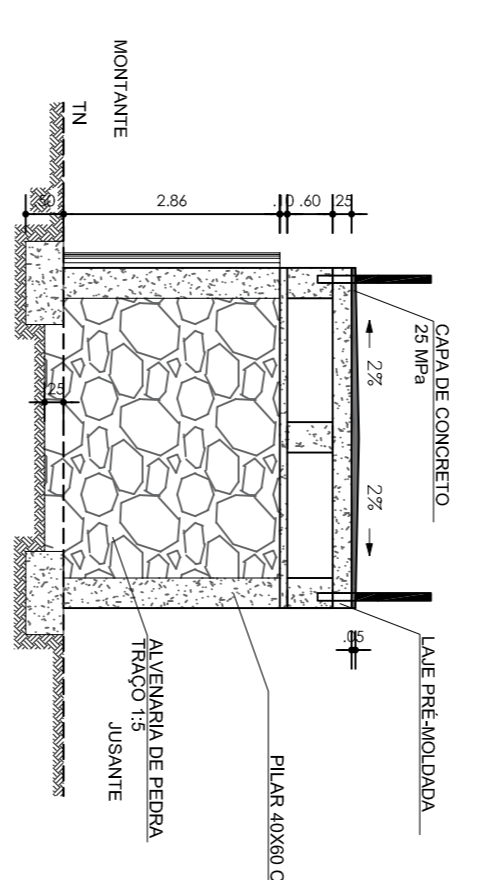

SEÇÃO 120E
 ESCALA 1:100

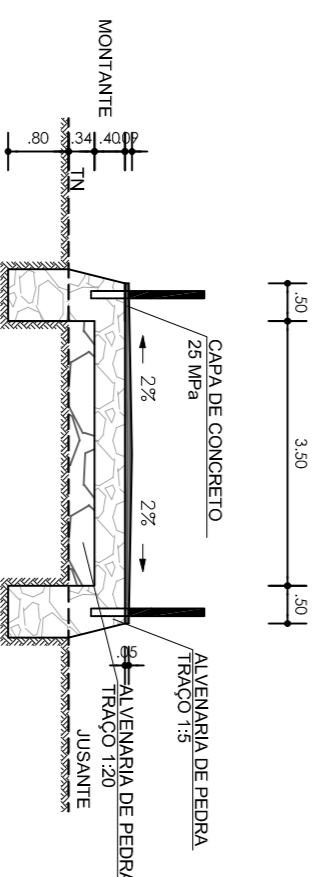

SEÇÃO 100E
 ESCALA 1:100

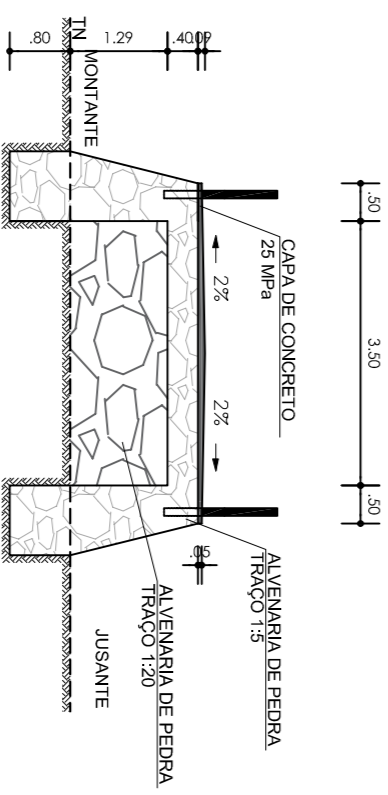

SEÇÃO 80E
 ESCALA 1:100

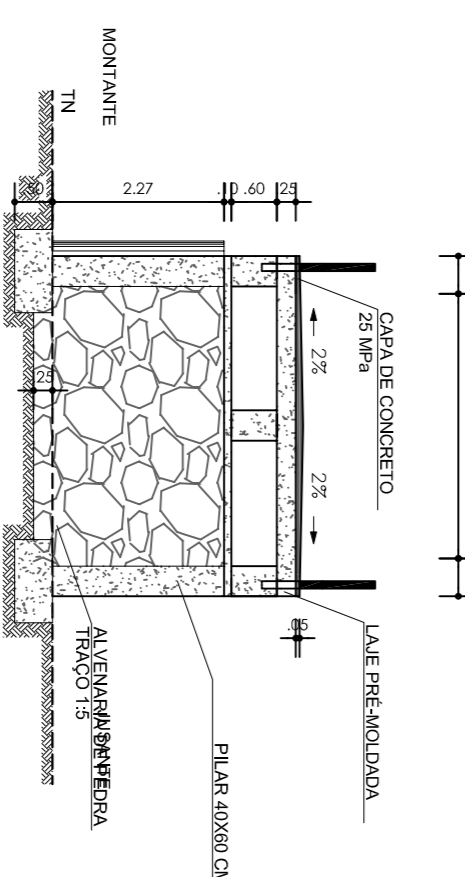



Projeto Específico
PASSAGEM MOLHADA
ITAETÉ - RIO PARAGUAGUÁ

Projeto de Implantação

PLANTA: SEÇÕES TRANSVERSAIS	NÚMERO: IMP. 02/03
PROJETO AUTORES: FRANCISSCO GIL VAM JARDIM CERILTON FERREIRA	CALCULOS:
VERSÃO/REVISÃO/ELABORADO: 1.0/01/2022	DATA: AGOSTO/2021
PROJETO: JESSICA FRANÇA	TRANSMISSÃO: ITAETÉ